

Struttura: alluminio a gravità, pressofuso ed estruso.

Viteria: inox.

Trattamento: anticorrosivo, elettroforesi catodica.

Verniciatura: polveri poliesteri.

Applicazione: base di ancoraggio.

Structure: gravity diecast aluminium, diecast and extruded aluminium.

Fasteners: stainless steel.

Coating: anti-corrosion, cathodic electrophoretic.

Paint finish: polyester powder.

Application: anchoring base.

Struktur: Aluminium-Schwerkraftguss und-druckguss, gepresstes Aluminium.

Schrauben: Edelstahl.

Behandlung: Korrosionsschutz, kathodische Elektrophorese.

Lackierung: Polyesterpulver.

Anwendung: Verankerungsbasis.

Structure: aluminium à gravité, moulé sous pression et extrudé.

Vis: inox.

Traitement: anticorrosion, électrophorèse cathodique.

Peinture: poudres polyester.

Application: base d'ancrage.

Estructura: aluminio por gravedad y fundido a presión, extrusión de aluminio.

Tornillería: inox.

Tratamiento: anticorrosivo, electroforesis catódica.

Pintado: polvos poliésteres.

Aplicación: base de anclaje.



LOCARNO

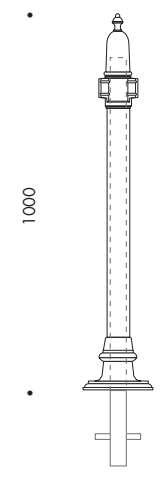
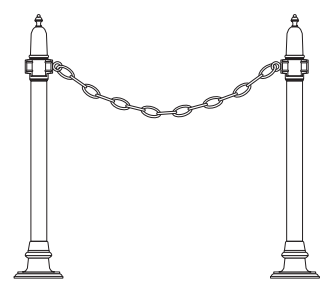

Ø186
DP60280



DP60281

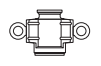

DP60282



DP60492

LONDRA

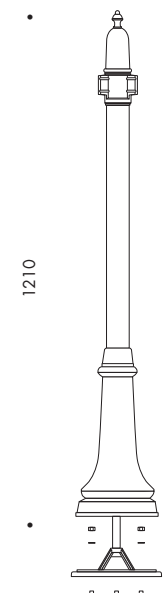
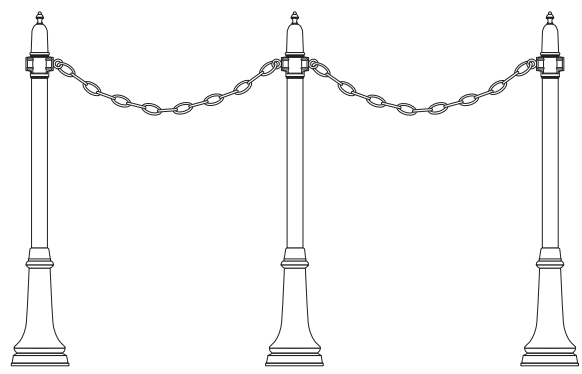

1210

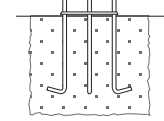

Ø216
DP61280



DP61281

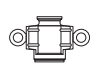

DP61282



DP61492

GINEVRA

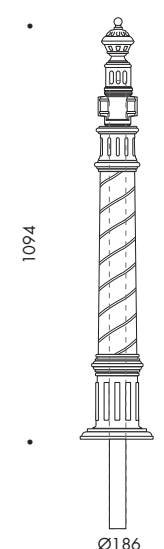
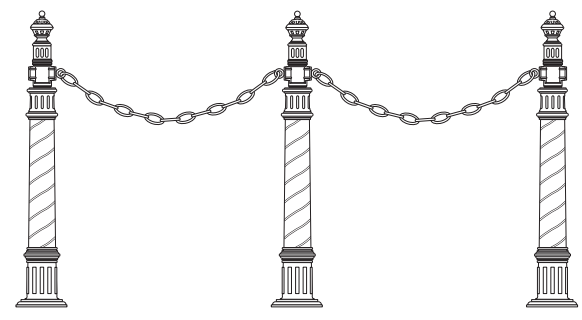

1094

Ø186
DP02280



DP02281

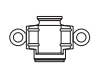

DP02282



DP02492

